

Wire joints

PT series crimp-on wire joints

- 01 Two-piece nylon insulator
- 02 One-piece non-insulated



PT series crimp-on wire joints



Cat. no.	Pkg. qty.	Wire range (AWG)		Rec. tool	Dimensions (in.)	
		min.	max.		A	B
PT66M	100	2#18	3#12 combination	WT161M	0.50	0.93
PT6M	100	—	Insulator only		0.50	0.93
PT60M	100	2#14	3#12 connector only		0.31	0.37
PT70	200	2#14	3#12		0.29	0.34
PT70M	200	3#18	4#12		0.31	0.37
PT80	50	2#16	4#10		0.35	0.62

Diagrams

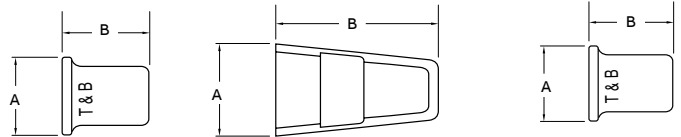

90 °C rated.

- 01 Twist wires, insert through serrated barrel of wire joint (PT60M, PT70, PT70M, PT80).

Installation procedure for "PT" connectors

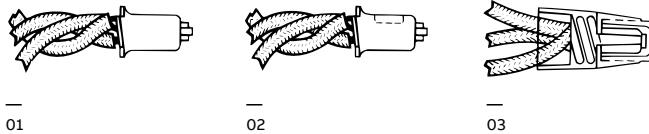

- 02 Crimp and trim off excess wire with WT161M hand tool.

- 03 Screw PT6 insulator firmly onto PT160M barrel.