

Juno® Pro-Series Xenon

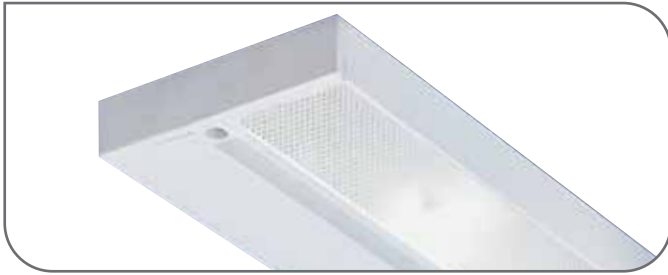

Pro-Series Xenon offers a slightly warmer color rendering than halogen in the same attractive, efficient Pro-Series package designed to maximize light output and minimize the cabinet bottom contact temperature. 10,000 hour lamp life is achieved by tuning the output voltage to the xenon lamp.

Performance Features

- 12-volt xenon lamps offer slightly warmer color rendering as compared to halogen
- Integral reflector spaced away from cabinet bottom maximizes light output while reducing fixture/cabinet contact temperature
- Dimmable with standard ELV type wall box dimmers or integral high/low/off rocker switch

Construction Features

- Slim 1" extruded aluminum profile
- Premium clear prismatic tempered glass lens for maximum light transmission and wipe down cleaning is reversed angled to minimize perceived fixture brightness
- Hinged lens captured by spring loaded retention bar, lens cannot accidentally fall out
- Integral state of the art 120 to 12-volt electronic transformer
- Choice of Designer White, Brushed Silver, Brushed Bronze or Black finish

Installation Features

- Modular design for maximum flexibility and quick installation allows up to 10 fixtures to plug together using the supplied internal straight connector or optional jumper cords
- Captive external mounting screws
- Rear wireway access cover with flush non-metallic cable clamp and push-in electrical connectors facilitate fast wiring without having to open fixture
- Miniature die-cast fitting for flexible metal conduit, off-center knock-outs and extra mounting plate for feed-through fixture-to-fixture loop wiring increase installation versatility

Finishes

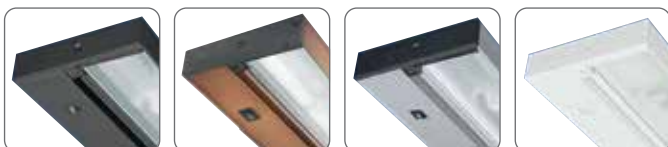

Black Brushed Bronze Brushed Silver Designer White

Listings UL/C-UL

Fixtures



UPX109 – 9" 1-Lamp Pro-Series Xenon

Supplied with joiner connector, mounting hardware and (1) 12V 20W bi-pin high output xenon lamp. 9-1/2"L x 4-1/2"D x 1"H

Finish: BL-Black, BZ-Brushed Bronze, SL-Brushed Silver, WH-Designer White

UPX214 – 14" 2-Lamp Pro-Series Xenon

Supplied with joiner connector, mounting hardware and (2) 12V 20W bi-pin high output xenon lamps. 14"L x 4-1/2"D x 1"H

Finish: BL-Black, BZ-Brushed Bronze, SL-Brushed Silver, WH-Designer White

UPX322 – 22" 3-Lamp Pro-Series Xenon

Supplied with joiner connector, mounting hardware and (3) 12V 20W bi-pin high output xenon lamps. 22"L x 4-1/2"D x 1"H

Finish: BL-Black, BZ-Brushed Bronze, SL-Brushed Silver, WH-Designer White

UPX430 – 30" 4-Lamp Pro-Series Xenon

Supplied with joiner connector, mounting hardware and (4) 12V 20W bi-pin high output xenon lamps. 30"L x 4-1/2"D x 1"H

Finish: BL-Black, BZ-Brushed Bronze, SL-Brushed Silver, WH-Designer White

Accessories



JC3 8IN, JC3 17IN, JC3 26IN – Jumper Cords

3-wire Jumper Cord to electrically join fixtures when spaced apart, turning corners, or spanning cabinet frames.

Finish: BL-Black, WH-Designer White

U6CP – 6' Cord and Plug

3-wire grounded cord and plug accessory for portable plug-in installation.

Finish: BL-Black, WH-Designer White

UDWM – Direct Wire Module

Facilitates code-compliant installation of fixture at front edge of cabinet. Includes wiring enclosure and 36" field-shortenable jumper cord that plugs into the right or left side of the fixture. 3"L x 3"D x 1"H

Finish: BL-Black, WH-Designer White

UCONN – 3/8" Miniature Die-Cast Electrical Connector

Accessory for use when loop wiring with non-metallic sheathed cable or BX.

UPXLAMP – 12V 20W Bi-Pin, High Output Xenon Replacement Lamp

Dimensions

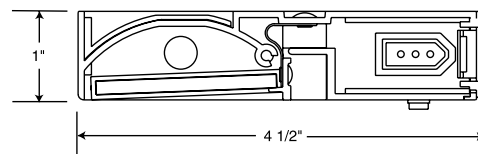

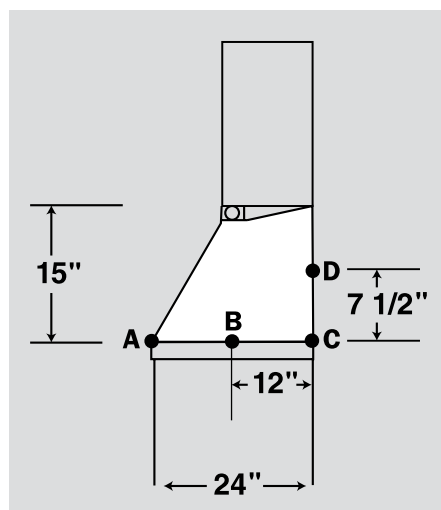
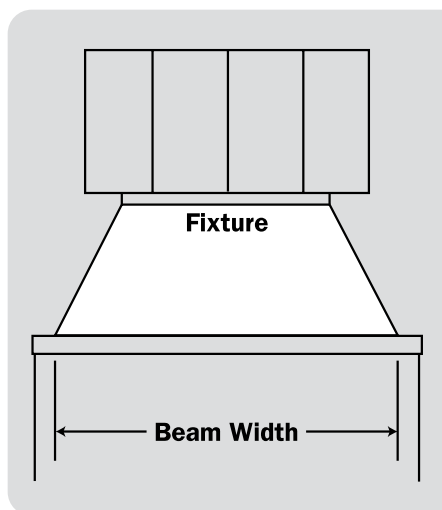

Footcandles on Horizontal Surface

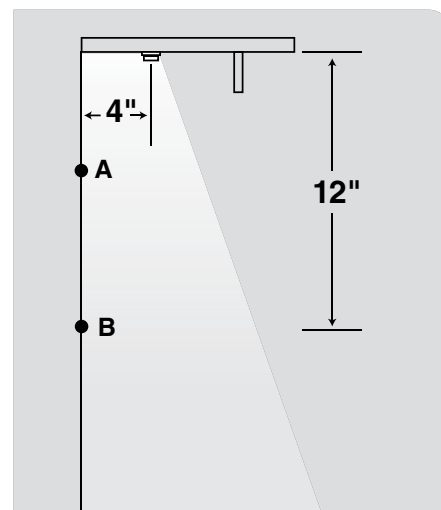

Footcandles on Vertical Surface (Color LED Modules)

Application Guide

Footcandles on Illuminated Surfaces

Fixture	Category #	Lamp	Beam Width*	Footcandles***			
				A	B	C	D
SoftTask™ LED	UPS09	24 LEDs	21"	18	78	58	58
	UPS14	36 LEDs	22"	27	114	86	85
	UPS22	55 LEDs	28"	35	144	113	105
	UPS30	72 LEDs	33"	39	155	124	111
	UPS40	98 LEDs	43"	52	197	168	145
Pro-Series LED	UPLED09	(2) 1-watt LEDs	20"	12	37	17	13
	UPLED14	(4) 1-watt LEDs	22"	22	64	31	24
	UPLED22	(6) 1-watt LEDs	28"	30	86	41	31
	UPLED30	(8) 1-watt LEDs	32"	35	97	50	38
Pro-Series Halogen	ULH109	(1) 20-watt Halogen	21"	8	29	26	34
	ULH214	(2) 20-watt Halogen	23"	14	52	46	52
	ULH322	(3) 20-watt Halogen	31"	23	72	63	59
	ULH430	(4) 20-watt Halogen	36"	23	74	69	61
Pro-Series Xenon	UPX109	(1) 20-watt High-Output Xenon	21"	9	31	28	35
	UPX214	(2) 20-watt High-Output Xenon	23"	15	53	48	54
	UPX322	(3) 20-watt High-Output Xenon	31"	24	72	65	62
	UPX430	(4) 20-watt High-Output Xenon	36"	23	75	69	64
Pro-Series Fluorescent	UPF12	8-watt T5 Fluorescent	21"	22	64	34	39
	UPF22	14-watt T5 HE Fluorescent	27"	37	105	59	65
	UPF34	21-watt T5 HE Fluorescent	34"	47	126	75	73
	UPF46	28-watt T5 HE Fluorescent	43"	61	162	100	96
Economy Fluorescent	UFL12	8-watt T5 Fluorescent	24"	32	77	68	93
	UFL22	14-watt T5 HE Fluorescent	31"	64	135	130	157
	UFL34	21-watt T5 HE Fluorescent	41"	66	140	131	140
	UFL46	28-watt T5 HE Fluorescent	50"	83	171	166	170

* Beam width defined at 50% of maximum footcandles. All data is for a single fixture. Fixture mounted at front lip of cabinet. Rear wall reflectance 50%. Counter Surface Reflectance 20%.

Photo Credits:

Cover: Fairview Builders, LLC Custom Home Builder, Model Home – Cliffs at Mountain Park
Page 1: Overstreet Builders, Model Home, Naperville, IL (Pictureboy Photography)



©2017 Acuity Brands Lighting, Inc. The marks appearing in this catalog are trademarks of Acuity Brands Lighting, Inc. Products shown in this brochure may be covered by U.S. and international patents and patents pending. Specifications subject to change without notice. Printed in the U.S.A.