



Class I, Div. 1 & 2, Groups B,C,D
Class I, Zones 1 & 2, Groups IIB, IIA
Class II, Div. 1 & 2, Groups E,F,G
Class III
NEMA 3, 4, 4X, 7(B,C,D) 9(E,F,G)

See Area Classification Chart below

FEATURES-SPECIFICATIONS

Applications

G Series custom control panel operators are designed for use in hazardous locations when installed in suitable enclosures such as B7E EXB, XJB, DB, SWB and GCS Series boxes and B7, Y7 Starter Enclosures.

Features

- Operators are all aluminum except for certain movable parts which are stainless steel, all other parts such as screws are either stainless steel or plated steel
- Threaded bodies are all 3/4"-14 NPSM thread
- Control stations can be grouped into a single assembly thus reducing installation time and cost
- Junction boxes may be used to mount operators along with glass lens for viewing internally mounted meters. Additional relays, timers, terminal blocks, or other equipment may also be internally mounted to provide a single centralized control unit.
- Custom operators other than standard assemblies listed may be ordered by proper catalog number from custom operator ordering system pages C40 & C41

Electrical Rating

Push button stations, selector switches Heavy duty 600 VAC max.
Pilot lights 120 VAC.

Dimensions

See Dimensional information for G Series operators on page C42.

Recommended Operator Selection

Short Style

DB/SWB/GCS Enclosures. Assemblies with wall thickness up to 1/2" thick.

Long Style

All B7E/XJB Enclosures. EXB (see page E12) enclosures with cover thickness up to 1-1/2" thick.

Extended Style

EXB larger size enclosures (see page E12) with cover thickness up to 2-1/2" thick.

Killark long and extended push buttons, selector switches, reset and

potentiometer operators are CENELEC/ATEX EExd IIB+H2 when installed in series EXB*CEN and GR*CEN enclosures.

For pilot lights and illuminated push buttons in CENELEC/ATEX applications see page C33.

| CONTACT BLOCK RATINGS | | | | | | |
|-----------------------|---------|---------|---------|---------|---------|---------|
| CURRENT | 120 VAC | 240 VAC | 480 VAC | 600 VAC | 125 VDC | 250 VDC |
| Inrush | 60 | 30 | 15 | 12 | .55 | .275 |
| Breaking | 6 | 3 | 1.5 | 1.2 | .55 | .275 |
| Carrying | 10 | 10 | 10 | 10 | 2.50 | 2.50 |

Note: Contact blocks can be stacked four deep maximum.

| AREA CLASSIFICATION CHART FOR OPERATORS | | | | | |
|---|-------------------|-------------------------------------|--------------------|-------------------------------------|----------------------|
| G01 ^④ | G017 ^② | G030 ^② | G057 ^② | G0L2 ^④ | G0L38 ^③ |
| G02 ^④ | G018 ^② | G034 ^② | G058 ^② | G0L3 ^④ | G0L39 ^③ |
| G05 ^④ | G019 ^② | G035 ^② G036 ^③ | G059 ^② | G0L4 ^④ | G0L113 ^③ |
| G06 ^④ | G021 ^② | G037 ^③ | G0113 ^③ | G0L5 ^④ | G0L114 ^③ |
| G07 ^④ | G022 ^② | G038 ^③ | G0114 ^③ | G0L6 ^④ | G0LRST ^④ |
| G08 ^③ | G023 ^② | G039 ^③ | G0133 ^② | G0L7 ^④ G0L8 ^③ | G0M1 ^⑤ |
| G010 ^④ | G025 ^② | G040 ^① | G0134 ^② | G0L14 ^④ | G0R11 ^④ |
| G014 ^④ | G026 ^② | G050 ^② | G0B3 ^④ | G0L15 ^④ | G0RST ^④ |
| G015 ^④ | G027 ^② | G051 ^② | G0B4 ^④ | G0L36 ^③ | G011388 ^② |
| G016 ^② | G028 ^② | G056 ^② | G0L1 ^④ | G0L37 ^④ | G011372 ^② |

① Class II Div. 1 & 2 Group EFG NEMA 9EFG
 ② Class I Div. 1 & 2 Group CD, Class II Div. 1 & 2 Group EFG, Class III NEMA 7CD, 9EFG
 ③ Class I Div. 1 & 2 Group BCD, Class II Div. 1 & 2 Group EFG, Class III NEMA 3, 4, 7BCD, 9EFG
 ④ Class I Div. 1 & 2 Group BCD, Class II Div. 1 & 2 Group EFG, Class III NEMA 3, 4, 4X, 7BCD, 9EFG
 ⑤ Class I Div. 1 & 2 Group CD, Class II Div. 1 & 2 Group EFG, Class III NEMA 3, 4, 7CD, 9EFG



Selector Switch

Class I, Div. 1 & 2, Groups B,C,D®
Class I, Zones 1 & 2, Groups IIB, IIA
Class II, Div. 1 & 2, Groups E,F,G
Class III
NEMA 3, 4, 4X, 7(B,C,D) 9(E,F,G)

See Area Classification Chart
page C40 for Details

Listed - File E12379

Certified - File LR11714
See files for details or call Killark.

FEATURES-SPECIFICATIONS

| G SELECTOR SWITCH MAINTAINED CONTACT | | | | |
|--------------------------------------|--------------|----------|----------------------------------|--------------------------------|
| CATALOG NUMBER ^① | | | CONTACT ARRANGEMENT ^② | TYPE OF OPERATION ^③ |
| SHORT ^④ | LONG | EXTENDED | | |
| G025-2A3F | G05-2A3F N34 | G0L52A3 | Left Right | Two position |
| G025-3C3G | G05-3C3G N34 | G0L53C3 | Left Center Right | Three position |
| G025-4H8H | G05-4H8H N34 | G0L54H8 | 1 2 3 4 | Four position |

| G SELECTOR SWITCH MAINTAINED CONTACT WITHOUT CONTACTS | | | | |
|---|--------------|--------|------|----------------|
| G025-2A0F | G05-2A0F N34 | G0L52A | None | Two position |
| G025-3C0G | G05-3C0G N34 | G0L53C | None | Three position |
| G025-4H0H | G05-4H0H N34 | G0L54H | None | Four position |

| G SELECTOR SWITCH SPRING RETURN | | | | |
|---------------------------------|-------------|--------|---------------------|---|
| G026-3F | G06-3F N34 | G0L63 | Left Right | Two position spring return to left |
| G027-6G | G07-6G N34 | G0L76 | Left Center Right | Three position spring return to center from right or left |
| G034-6G | G014-6G N34 | G0L146 | Left Center Right | Three position spring return to center from right, maintain in left |
| G035-6G | G015-6G N34 | G0L156 | Left Center Right | Three position spring return to center from left, maintain in right |

| G SELECTOR SWITCH SPRING RETURN WITHOUT CONTACTS | | | | |
|--|-------------|-------|------|---|
| G026-0F | G06-0F N34 | G0L6 | None | Two position spring return to left |
| G027-0G | G07-0G N34 | G0L7 | None | Three position spring return to center from right or left |
| G034-0G | G014-0G N34 | G0L14 | None | Three position spring return to center from right, maintain in left |
| G035-0G | G015-0G N34 | G0L15 | None | Three position spring return to center from left, maintain in right |

^① Refer to catalog page C30 to select proper operator for enclosure, C38 & C39 for Accessories, C30 for complete details on Area Classification of operators, C42 for Dimensional Information, C40 for Special Contact Configurations.

^② Nameplates are Double sided. 2 position marked ON-OFF and Blank on other side.

3 position marked HAND-OFF-AUTO and Blank on other side. 4 position is Blank.

^③ Contact Blocks are shown in their normal position.

^④ Short style operators are suitable for Class I Group C & D, Class II Group E,F,G only.

| CHART 1 - SINGLE BUTTON | | | | |
|-------------------------|-------------|-------------|-------------|-------|
| GO1 SYMBOL | GO21 SYMBOL | GOL1 SYMBOL | GOM1 SYMBOL | COLOR |
| KX | KZ | K | KM | Black |
| RX | RZ | R | RM | Red |
| GX | GZ | G | GM | Green |

| CHART 2 - DOUBLE BUTTON | |
|-------------------------|-------------|
| SYMBOL | COLOR |
| KK | Black/Black |
| GG | Green/Green |
| RR | Red/Red |
| RG | Red/Green |
| KR | Black/Red |
| KG | Black/Green |

| CHART 3 - PILOT LIGHT LENS | |
|----------------------------|---------|
| SYMBOL | COLOR |
| A | Amber |
| B | Blue |
| C | Clear |
| F | Frosted |
| G | Green |
| R | Red |

| CHART 4 - CONTACT BLOCKS | |
|--------------------------|---------------------------------------|
| SYMBOL | ARRANGEMENT |
| 1 | One N.O. block |
| 2 | One N.C. block |
| 3 | One universal (One N.O. and one N.C.) |
| 4 | One delayed break N.C. block |
| 5 | One early make N.O. block |
| 6 | Two N.O. blocks |
| 7 | Two N.C. blocks |
| 8 | Two universal (Two N.O. and two N.C.) |
| 0 | Omit contact block |

| CHART 5 - SELECTOR SWITCHES | |
|-----------------------------|------------------|
| SYMBOL | NO. OF POSITIONS |
| 2 | Two |
| 3 | Three |

| CHART 6 - PILOT LIGHT LAMPS | | |
|-----------------------------|------------------|---------|
| GO23 SYMBOL | GOB3/GOB4 SYMBOL | VOLTAGE |
| 23 | 23 | 120 |
| 4 | 4 | 24 |

| CHART 7A - SELECTOR SWITCH CAMS | | | | | | | | |
|--|-----------------|---------------|-----------------|-------------|--------------|----------------|--------------|--|
| CAM AND CONTACT SELECTION TABLE FOR 2 AND 3 POSITION SELECTOR OPERATOR | | | | | | | | |
| | | Left position | Center position | | | Right position | | |
| SYMBOL | CONTACTS BLOCKS | LEFT BLOCKS | RIGHT BLOCKS | LEFT BLOCKS | RIGHT BLOCKS | LEFT BLOCKS | RIGHT BLOCKS | |
| A | NC | X | X | | | 0 | 0 | |
| | NO | 0 | 0 | | | X | X | |
| B | NC | X | 0 | X | X | 0 | X | |
| | NO | 0 | X | 0 | 0 | X | 0 | |
| C | NC | X | X | 0 | 0 | 0 | 0 | |
| | NO | 0 | 0 | 0 | 0 | X | X | |
| D | NC | 0 | 0 | X | X | 0 | 0 | |
| | NO | 0 | 0 | 0 | 0 | X | X | |
| E | NC | 0 | 0 | X | X | 0 | 0 | |
| | NO | X | X | 0 | 0 | 0 | 0 | |
| G | NC | X | 0 | 0 | X | 0 | 0 | |
| | NO | 0 | 0 | 0 | 0 | X | X | |

Note: Spring return operators are supplied with special fixed cam. Changes cannot be made for cam substitution.

| CHART 7B | |
|----------|-------------|
| CAM | PART NUMBER |
| A | 0106775B |
| B | 11586ABAB |
| C | 11587ABAB |
| D | 11588ABAB |
| E | 11589ABAB |
| G | 11590ABAB |

| CHART 8 - NAMEPLATES [Ⓛ] | | | |
|-----------------------------------|-------------------------|----------------|--|
| SYMBOL | NAMEPLATE MARKINGS | | G SERIES FORMS THAT NAMEPLATE CAN BE USED ON |
| | FRONT | BACK | |
| A | Omit nameplate | Omit nameplate | All |
| B | Start | Stop | GO1, 21, 23, 20, 40, GOB3 |
| C | Blank | Reset | GO1, 21, 23, 20, 40, GOB3, GOB4 |
| E | Blank | On | GOR4 |
| F | Blank-Blank | Off-On | GO5, 25, 6, 26, 8, 28, 10, 30, 36, 56 |
| G | Blank-Blank-Blank | Hand-Off-Auto | GO5, 25, 7, 27, 8, 28, 10, 30, 14, 34 |
| H | Blank-Blank-Blank-Blank | Start-Stop | GO5, 25, 10, 30 |

| CHART 9 - KEY LOCK | |
|--------------------|------------------------------|
| SYMBOL | TYPE |
| 22 | 2 Position key remove left |
| 20 | 2 Position key remove both |
| 32 | 3 Position key remove center |
| 30 | 3 Position key remove all |

| CHART 10 - KEY STYLE | |
|----------------------|----------------|
| SYMBOL | TYPE |
| D | Keys different |
| A | Keys alike |

[Ⓛ] Symbol not required on extended length GOL part number.



| G DIMENSIONS | | | | | |
|-----------------------------------|--------|--------------|--------------|-------------------|---------------|
| SERIES | FIGURE | A | B | C | D |
| GO1 | 1 | 15/16" (24) | 1-3/4" (44) | 3-7/16" (87) | 1-1/4" (32) |
| GO2 | 3 | 13/16" (21) | 2" (51) | 3-3/4" (95) | — |
| GOB3 | 4 | 1-1/8" (29) | 2" (51) | 2-3/4" (70) | 1-9/16" (40) |
| GOB4 | 5 | 2-3/8" (60) | 2-1/4" (57) | 4" (101) | 1-13/16" (46) |
| GO5 | 9 | 1-5/16" (33) | 1-3/4" (44) | 3-7/16" (87) | 1-1/4" (32) |
| GO6,GO7,GO14,GO15 | 9 | 1-5/16" (33) | 1-3/4" (44) | 3-13/16" (97) | 1-1/4" (32) |
| GO8 | 10 | 2-9/16" (65) | 1-3/4" (44) | 3-1/2" (89) | 1-1/4" (32) |
| GO10 | 11 | 1-5/16" (33) | 1-3/4" (44) | 4" (101) | 1-1/4" (32) |
| GO16,GO18 | 7 | 1-1/4" (32) | 1" (25) | 13/16" (21) | 1-1/2" (38) |
| GO17,GO19 | 7 | 13/16" (21) | 1" (25) | 13/16" (21) | 1-1/2" (38) |
| GO21 | 1 | 15/16" (24) | 3/4" (19) | 2-7/16" (62) | 1-1/4" (32) |
| GO22 | 3 | 13/16" (21) | 1" (25) | 2-3/4" (70) | — |
| GO23 | 4 | 1-1/8" (29) | 1" (25) | 1-3/4" (44) | 1-9/16" (40) |
| GO25 | 9 | 1-5/16" (33) | 3/4" (19) | 2-7/16" (62) | 1-1/4" (32) |
| GO26,GO27,GO34,GO35 | 9 | 1-5/16" (33) | 3/4" (19) | 2-13/16" (71) | 1-1/4" (32) |
| GO30 | 11 | 1-5/16" (33) | 3/4" (19) | 3" (76) | 1-1/4" (32) |
| GO36,GO37,GO38,GO39 | 10 | 2-9/16" (65) | 1-3/4" (44) | 3-7/8" (98) | 1-1/4" (32) |
| GO40 | 2 | 15/16" (24) | 11/16" (17) | 1" (25) | 1-1/4" (32) |
| GO50 | 7 | 1-1/2" (38) | 2" (51) | 6-5/16" (160) | 2-5/16" (59) |
| GO51 | 7 | 2-1/4" (57) | 1-5/8" (41) | 5-9/16" (141) | 1" (25) |
| GO56,GO57,GO58,GO59 | 10 | 2-9/16" (65) | 3/4" (19) | 2-7/8" (73) | 1-1/4" (32) |
| GO113,GO114 | 6 | 1" (25) | 2" (51) | 3-5/8" (67) | 1-13/16" (46) |
| GO133,GO134 | 6 | 1" (25) | 1" (25) | 2-5/8" (67) | 1-13/16" (46) |
| GO-11388-078 | 8 | 1-5/16" (33) | 3/4" (19) | N/A | 1-1/2" (38) |
| GO-11372-093 | 8 | 1-5/16" (33) | 3/4" (19) | N/A | 1-1/2" (38) |
| GOR11 | 3 | 13/16" (21) | 2" (51) | 4-1/8" (105) | — |
| GO-RST | 2 | 15/16" (24) | 2-5/16" (59) | 2-3/8" (+6") (60) | 1-1/4" (32) |
| GOM1 | 1 | 1-7/8" (48) | 1-7/16" (37) | 4" (101) | 1-5/8" (41) |
| EXTENDED LENGTH OPERATORS: | | | | | |
| GOL1 | 1 | 15/16" (24) | 2-3/4" (70) | 4-7/16" (113) | 1-1/4" (32) |
| GOL2 | 3 | 13/16" (21) | 2-3/4" (70) | 4-1/2" (114) | — |
| GOL3 | 4 | 1-1/8" (29) | 2-3/4" (70) | 3-3/8" (86) | 1-9/16" (40) |
| GOL4 | 5 | 2-3/8" (60) | 2-3/4" (70) | 4-5/8" (117) | 1-13/16" (46) |
| GOL5 | 9 | 1-5/16" (33) | 2-3/4" (70) | 4-7/16" (113) | 1-1/4" (32) |
| GOL6,GOL7,GOL14,GOL15 | 9 | 1-5/16" (33) | 2-3/4" (70) | 4-13/16" (122) | 1-1/4" (32) |
| GOL8 | 10 | 2-9/16" (65) | 2-3/4" (70) | 4-1/2" (114) | 1-1/4" (32) |
| GOL36,GOL37,GOL38,GOL | 10 | 2-9/16" (65) | 2-3/4" (70) | 4-7/8" (124) | 1-1/4" (32) |
| GOL113,GOL114 | 6 | 1" (25) | 3" (76) | 4-5/8" (117) | 1-13/16" (46) |
| GOLRST | 2 | 15/16" (24) | 2-3/4" (70) | 3" (+6") (76) | 1-1/4" (32) |

NOTE: All operators are for installation into a 3/4"-14 NPSM opening except GO50 which is for 1-1/4"-11-1/2 NPSM and GO-11388-078 + GO-11372-093 which are for use in a 3/4"-14 NPT opening.

Special Operators

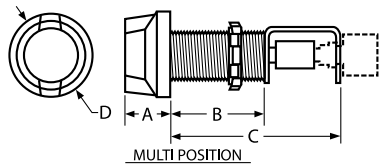

FIGURE 6

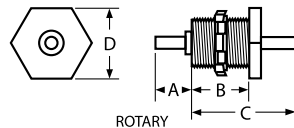

FIGURE 7

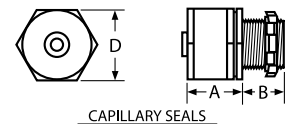

FIGURE 8

Selector Switches

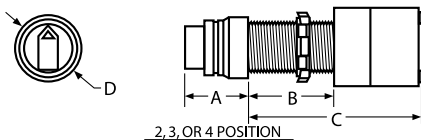

FIGURE 9

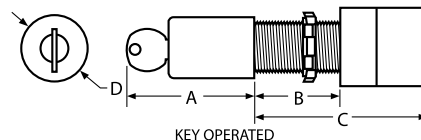

FIGURE 10

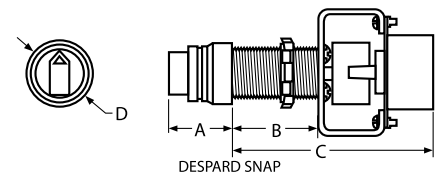

FIGURE 11

Push Buttons

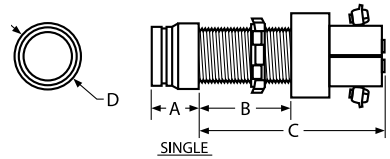

FIGURE 1

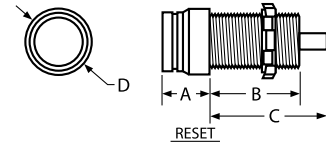

FIGURE 2

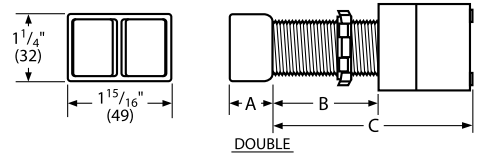

FIGURE 3

Pilot Lights

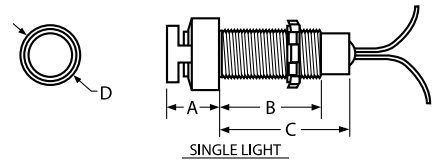

FIGURE 4

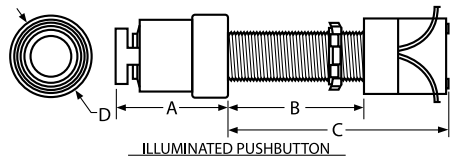

FIGURE 5

