

of Contacts + Ground Connection

Bases – Standard Mount				6	10	16		
SINGLE LEVER	DOUBLE LEVER	HOUSING	NPT ENTRY	LEVER LOCKING TYPE				
				SINGLE	SINGLE	DOUBLE	SINGLE	DOUBLE
		Panel Base w/Cover		PB306** PB406**	PB310 PB410**	PB110E	PB316** PB416**	PB116E
		Box Base no Cover	1 X 1/2" 1 X 3/4" 1 X 1" 2 X 1/2" 2 X 3/4" 2 X 1"	BB406 BB406H075 BB406H100 BB506 BB506H075 BB506H100	BB410 BB410H075 BB410H100 BB510 BB510H075 BB510H100	BB010E BB010EH075 BB010EH100 BB110E BB110EH075 BB110EH100	BB416* BB416H100	BB016E* BB016EH100
		Box Base w/Cover	1 X 1/2" 1 X 3/4" 1 X 1" 2 X 1/2" 2 X 3/4" 2 X 1"	BB606** BB606H075** BB606H100** BB706** BB706H075** BB706H100**	BB610** BB610H075** BB610H100** BB710** BB710H075** BB710H100**		BB616* ** BB616H100**	

Hoods — Standard Mount				<i>*Plastic body — "B" 3-16 Series standard Hoods include Gaskets: Bases and Special Hoods do not.</i>				
		Side Entry	1 X 1/2" 1 X 3/4" 1 X 1"	SH606 SH606H075 SH606H100	SH610 SH610H075 SH610H100	SH010 SH010H075 SH010H100	SH616 [†] SH716H [†]	SH016 [†] SH116H
		Top Entry	1 X 1/2" 1 X 3/4" 1 X 1"	TH806 TH806H075 TH806H100	TH810 TH810H075 TH810H100	TH210 TH210H075 TH210H100	TH816 [†] TH816H100	TH216 [†] TH316H

Coupler Hoods – Inline				<i>For Inline, Portable or Special Service Connections. Coupler Hoods mate to Standard Hoods ONLY.</i>				
		Top Entry	1 X 1/2" 1 X 3/4" 1 X 1"	CH806H CH806H075 CH806H100	CH810E CH810H075 CH810H100	CH610E CH610EH075 CH610EH100	CH816H CH916H	CH616EH CH716EH

Lever Hoods – Reverse Locking				<i>Lever Hoods mate to Post Bases ONLY.</i>				
		Side Entry w/Lever(s)	1 X 1/2" 1 X 3/4" 1 X 3/4"			LH010E LH010EH075 LH010EH100		LH016E* LH116EH
		Top Entry w/Lever(s)	1 X 1/2" 1 X 3/4" 1 X 1"			LH210E LH210EH075 LH210EH100		LH216E* LH316EH

Bases – with Access Cover				<i>Post Bases accept Lever Hoods ONLY.</i>				
		Panel+ Posts w/Cover				PB210**		PB216**
		Box Base+ Posts w/Cover	1 X 1/2" 1 X 3/4" 1 X 1" 2 X 1/2" 2 X 3/4" 2 X 1"			BB210** BB210H075** BB210H100** BB310** BB310H075** BB310H100**		BB216* ** BB216H100** BB316** BB316H100**

* Notes: Available in Standard or HIGH Profile "H" configurations. (-add suffix)

** Add "M" final suffix for metal cover option.

† Both HIGH (H) and LOW (L) profile also available. (-add suffix)

Pos-E-Kon® Pin and Sleeve Connectors

Mounting Dimensions for Double Post Box Bases (Reverse Locking)

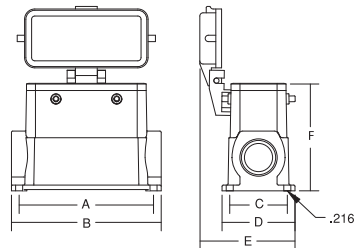

HOUSING SERIES				CAT. NO.	DIMENSIONS ARE IN INCHES / (MILLIMETRES)					
A, B, T, K	C, V	D	DD		A	B	C	D	E	F
A32		D50		BB_32A	3.70 / (94)	4.17 / (106)	1.81 / (46)	2.32 / (59)	3.11 / (79)	3.20 / (81.5)
				BB_32A100	3.70 / (94)	4.17 / (106)	1.81 / (46)	2.32 / (59)	3.11 / (79)	3.20 / (81.5)
B10, T10	V3		DD42	BB_10	3.23 / (82)	3.66 / (93)	1.56 / (40)	2.05 / (52)	2.87 / (73)	2.05 / (52)
				BB_10H	3.23 / (82)	3.66 / (93)	1.77 / (45)	2.24 / (57)	2.97 / (75.5)	2.91 / (74)
B16, T16	C6, V6	D40	DD72	BB_16	4.13 / (105)	4.61 / (117)	1.77 / (45)	2.24 / (57)	2.97 / (75.5)	2.68 / (68)
				BB_24	5.20 / (132)	5.67 / (144)	1.77 / (45)	2.24 / (57)	2.97 / (75.5)	2.68 / (68)
B24, T24 K12	C6, V6	D40	DD72	BB_24	5.20 / (132)	5.67 / (144)	1.77 / (45)	2.24 / (57)	2.97 / (75.5)	2.68 / (68)
				BB_24H	5.20 / (132)	5.67 / (144)	1.77 / (45)	2.24 / (57)	2.97 / (75.5)	3.31 / (84)

H - High Profile

Mounting Dimensions for Double Post Panel Bases (Reverse Locking)

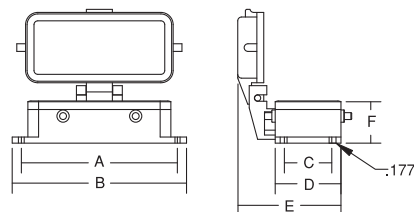

HOUSING SERIES				CAT. NO.	DIMENSIONS ARE IN INCHES / (MILLIMETRES)					
A, B, T, K	C, V	D	DD		A	B	C	D	E	F
A32		D50		PB232A	3.62 / (92)	4.02 / (102)	1.65 / (42)	2.24 / (57)	3.15 / (80)	1.10 / (28)
B10, T10	V3		DD42	PB210	3.27 / (83)	3.66 / (93)	1.26 / (32)	1.69 / (43)	2.68 / (68.5)	1.06 / (27)
B16, T16	C6, V6	D40	DD72	PB216	4.06 / (103)	4.49 / (114)	1.26 / (32)	1.69 / (43)	2.68 / (68.5)	1.06 / (27)
B24, T24 K12	C6, V6	D40	DD72	PB224	5.12 / (130)	5.51 / (140)	1.26 / (32)	1.69 / (43)	2.68 / (68.5)	1.06 / (27)